



**ZONING NOTE**

CURRENT ZONING DETERMINATION IS RM-10-B  
 BUILDING HEIGHT LIMITED TO ONE-HALF THE HEIGHT OF THE BUILDING  
 194.2' = BUILDING HEIGHT TO TOP OF MECHANICAL ROOM/ROOF  
 99.37' = BUILDING SIDE LOT SET BACK  
 BUILDING SIDE LOT SET BACK DOES NOT PERTAIN TO PROPOSED RETAINING WALL  
**LOCATION MAP**  
 SECTION 19, TOWNSHIP 49 SOUTH, RANGE 43 EAST  
 (NOT TO SCALE)

**LEGEND:**

-  DENOTES EXISTING ELEVATION
-  CATCH BASIN

**LEGAL DESCRIPTION:**

ACCORDING TO THE PLAT THEREOF  
 RECORDED IN PLAT BOOK 58,  
 PAGE 24, OF THE PUBLIC RECORDS OF  
 BROWARD COUNTY, FLORIDA,  
 TOGETHER WITH THE NORTH 194.93 FEET,  
 (AS MEASURED AT RIGHT ANGLES)  
 OF LOT 25, SAID BLOCK 34.

**"GALT OCEANS MILE,  
 ADDITION NO. 2"**

SECTION 19, TOWNSHIP 49 SOUTH, RANGE 43 EAST  
 CITY OF FORT LAUDERDALE,  
 BROWARD COUNTY, FLORIDA.

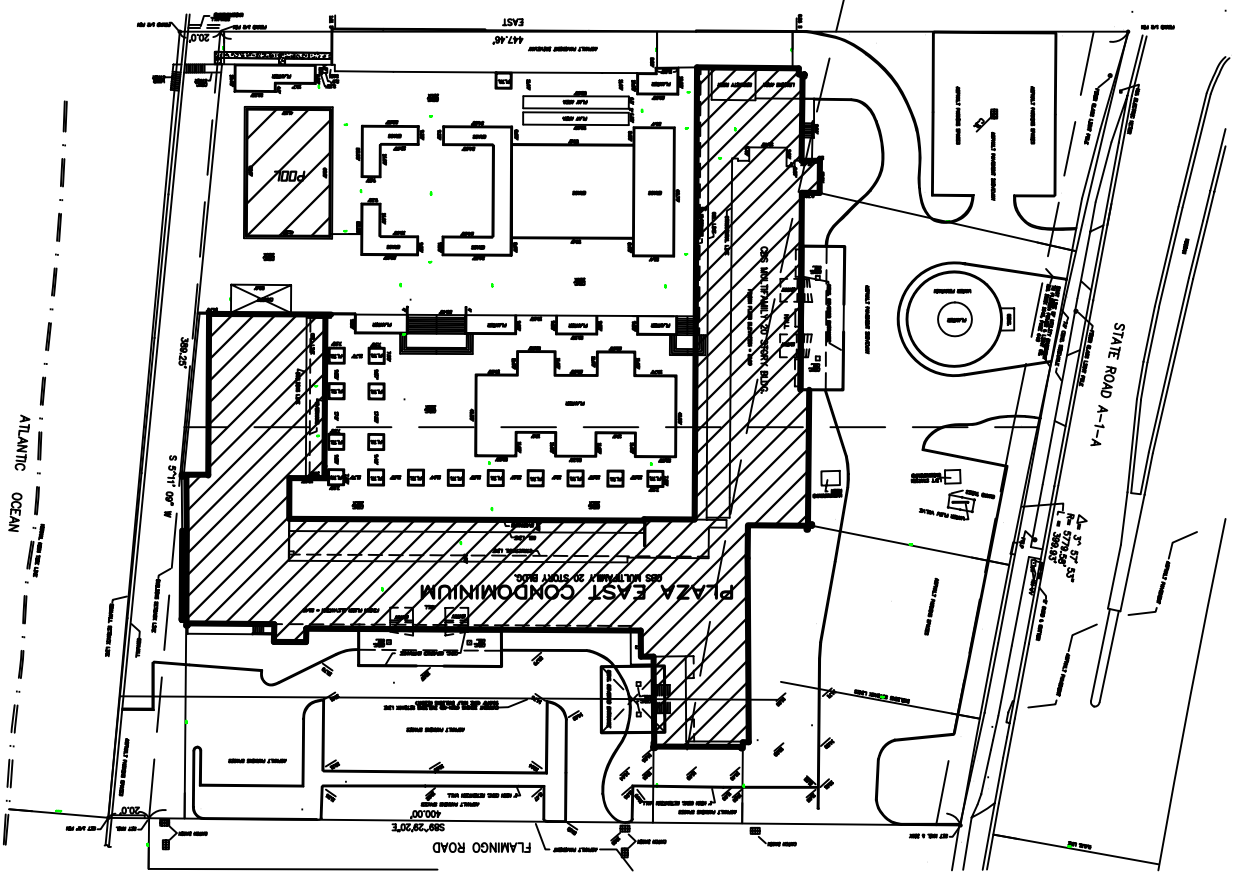
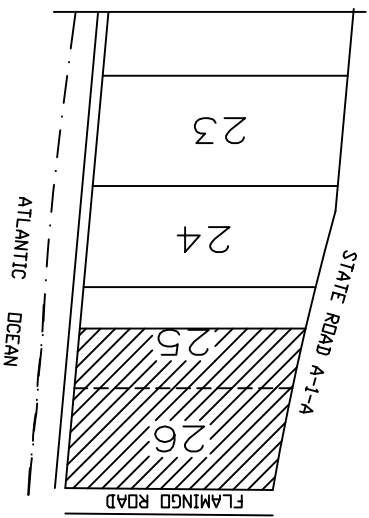

**EXISTING SITE PLAN OF PLAZA EAST**



ARCHITECTURAL SITE PLAN  
 DRAWING SCALE AS SHOWN  
 DO NOT SCALE DRAWINGS  
 CONTRACTOR MUST VERIFY CONDITIONS  
 PRIOR TO WORK VERIFY ALL FIELD CONDITIONS

PLAZA EAST CONDOMINIUM  
 4300 NORTH OCEAN BLVD  
 FORT LAUDERDALE FLORIDA 33308  
 BASED ON SURVEY BY KARL F. KUHN - DATED 8/7/03  
 PROFESSIONAL LAND SURVEYOR NO. 5953  
 STATE OF FLORIDA



RICHARD LOARIE, AIA, ARCHITECT  
 FLORIDA LICENSE AR-0014217  
 4300 NORTH OCEAN BLVD, SUITE 2F  
 FORT LAUDERDALE, FL 33308  
 PHONE: (954) 564-6699  
 FAX: (954) 564-6699